

Quick Installation Manual
APX 5.0~30.0P-S2

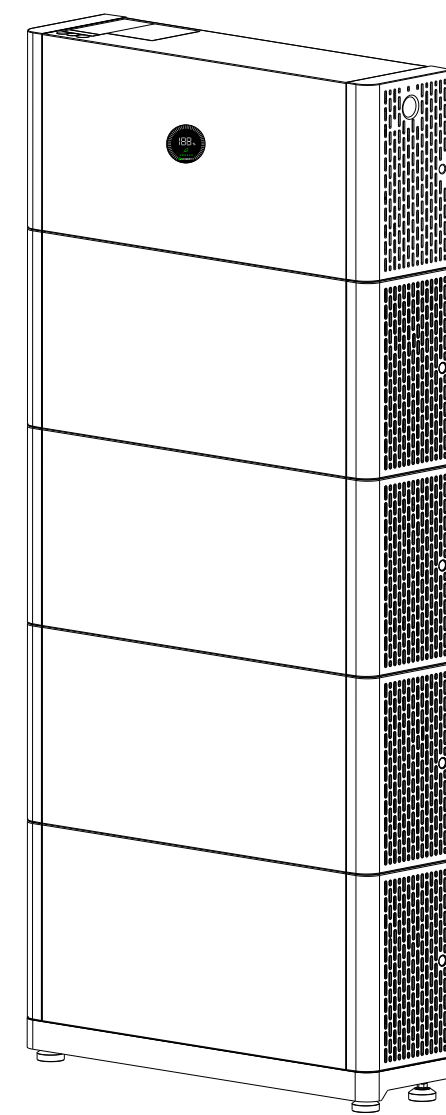

Environment requirements

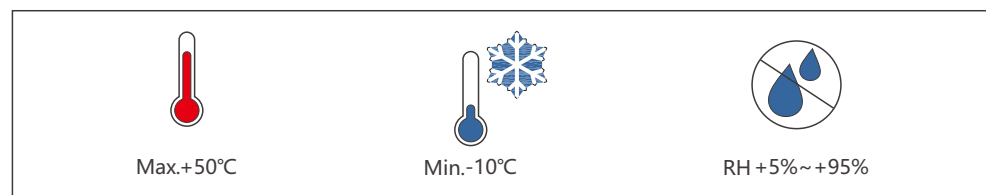

Installation tools

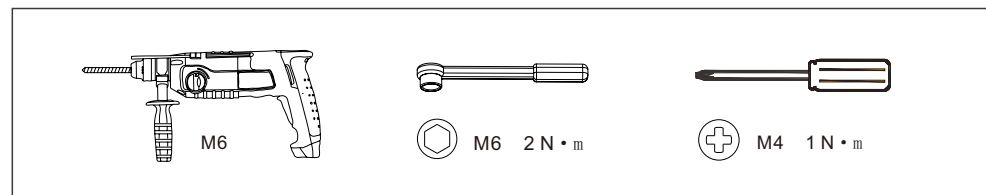

Dimensions

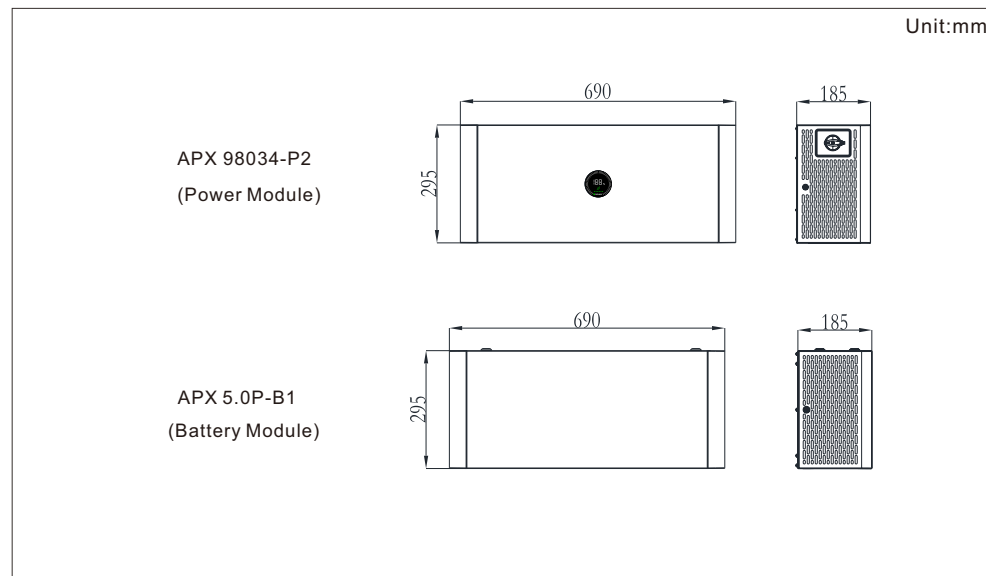

1. Inspection upon delivery

1-1 Checking the APX 98034-P2 packing list

Please check that the contents are complete

APX 98034-P2 (PM)

- A Operation Manual *1
- B Quick installation manual *1
- C Warranty Card *1
- D Marking-off template
- E Marking-off template *1

System cable

- A Protective rubber ring *4
- B Anti-tipping plate *2
- C M6 expansion screw *2
- D M6x12 stainless steel screw *1
- E M4x9 stainless steel screw *3

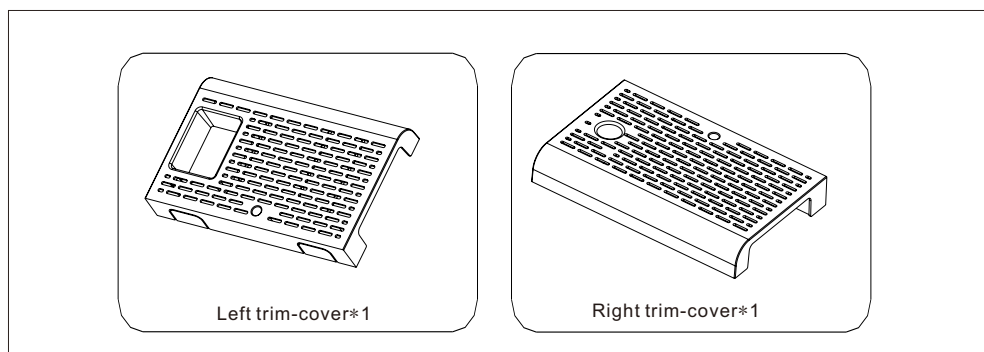

1-2 Checking the APX 5.0P-B1 packing list

APX 5.0P-B1 (BM)

- Parallel cable *1
- Trim-cover *2
- Warranty card *1
- A Anti-tipping plate *2
- B M6 expansion screw *2
- C M4x9 stainless steel screw *3

1-3 Check accessories

APX 5.0P-B1

- A APX 98034-P2
- B APX 5.0P-B1
- C Wall bracket *4
- D APX 5.0P-B1 Parallel extension cable
- E APX 5.0P-B1 Base
- F Cascading cable

Battery Capacity	Floor-mounted Installation Compound Mode	Wall-Mounted Installation Compound Mode
5kWh	A+B+E	A+B+C
10kWh	A+B*2+E	A+B*2+C
15kWh	A+B*3+E	A+B*3+C
20kWh	A+B*4+E	A+B*4+C
25kWh	A+B*5+E*2+D	A+B*5+C*2+D
30kWh	A+B*6+E*2+D	A+B*6+C*2+D
40kWh	A*2+B*8+E*2+F	A*2+B*8+C*2+F
50kWh	A*2+B*10+E*4+D*2+F	A*2+B*10+C*4+D*2+F
60kWh	A*2+B*12+E*4+D*2+F	A*2+B*12+C*4+D*2+F

2. Installation Environment Requirement

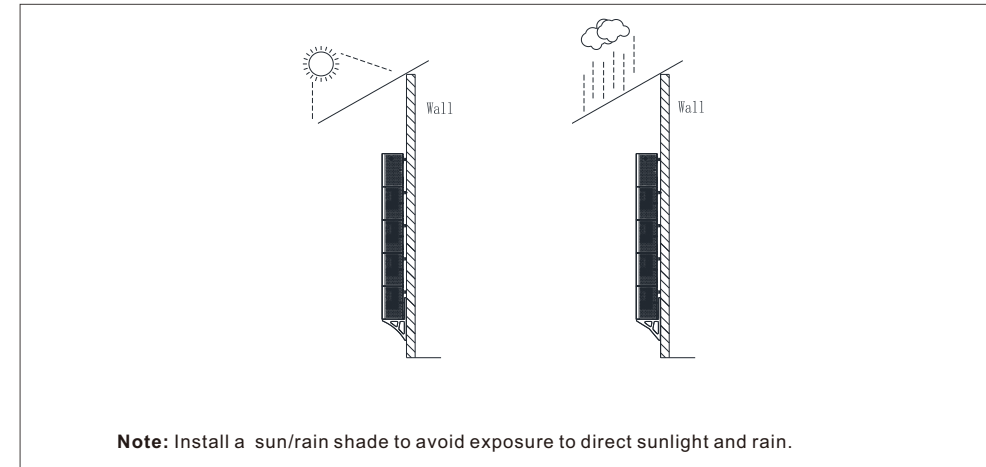

3. Floor-mounted installation

3-1 Installation Location Requirements

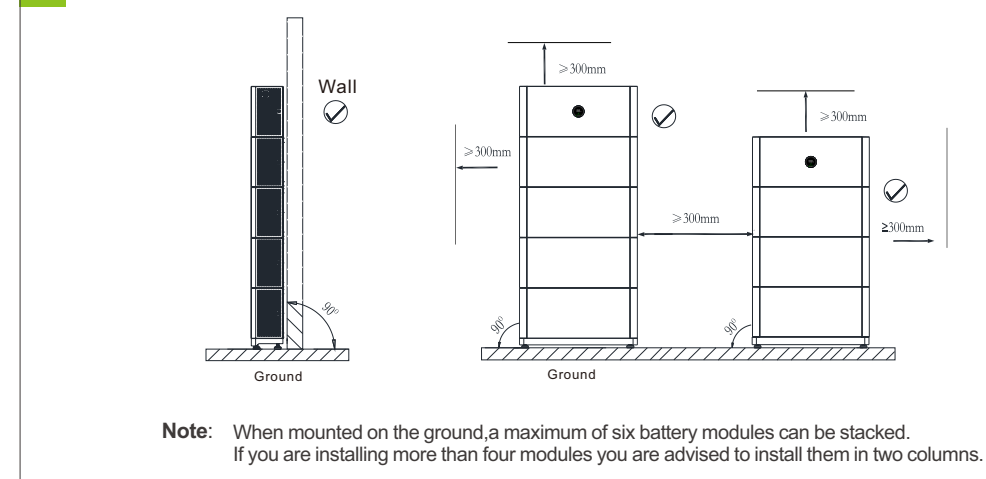

3-2 Installation Procedure

Mounting Hole Dimensions

Unit: mm

- Install the connecting pieces on both sides and tighten the two screws.
- Level the battery module using a level.
- Install the anti-tipping plates on both sides and tighten the two screws.
- Mark the hole positions.
- Mark the hole positions.

- The marking-off template ensures that the alignment marks are properly.
- Fix the M6 expansion screw into the wall.
- Secure the module on both sides to the wall.

- Loosen two screw, move up the handle on both sides.
- Tighten the two screws, fix the two battery modules.
- Secure the module on both sides to the wall.
- Secure the module on both sides to the wall.

- Loosen two screw, move up the handle on both sides.
- Tighten the two screws, fix the battery and the power modules.
- Install the connecting pieces on both sides and tighten the two screws.
- Secure the module on both sides to the wall.

4. Wall-Mounted Installation

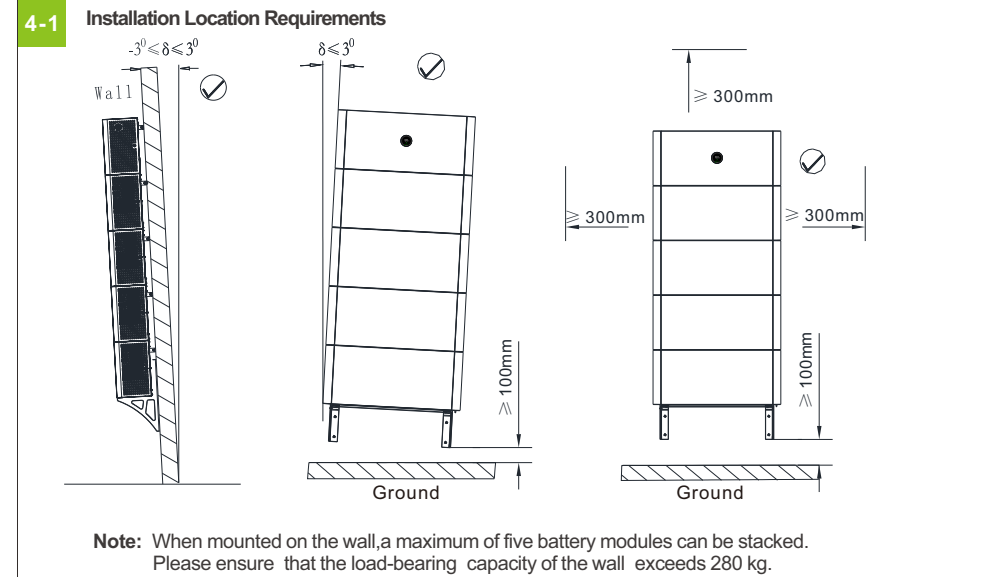

4-2 Installation Procedure

Mounting Hole Dimensions

Unit: mm

install the wall bracket

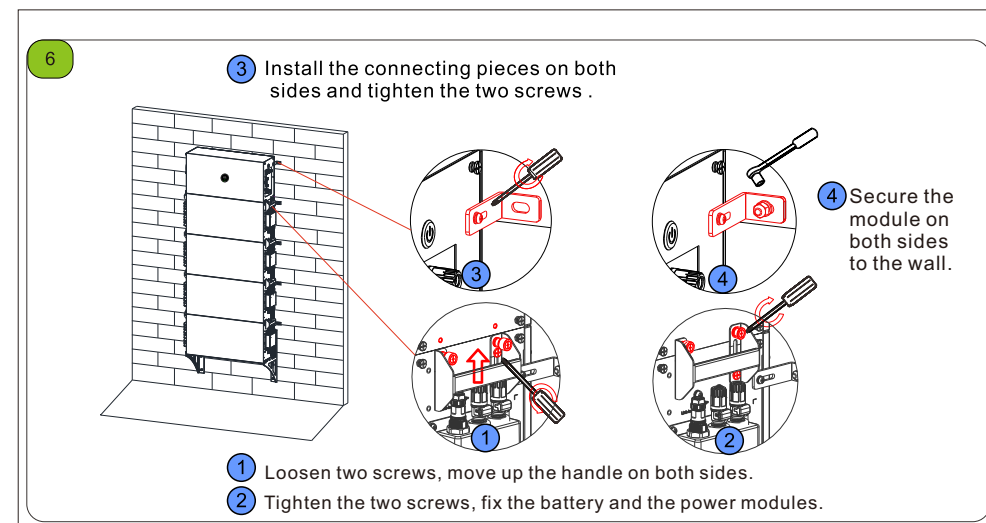
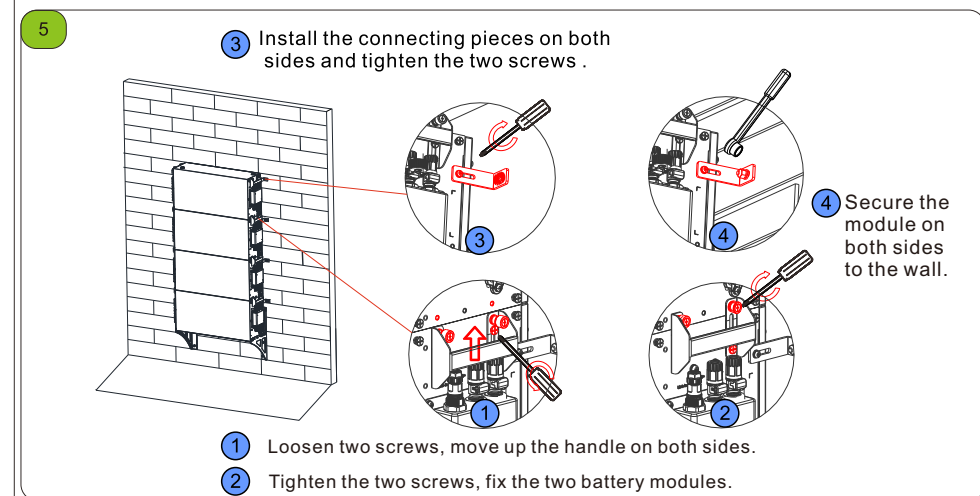
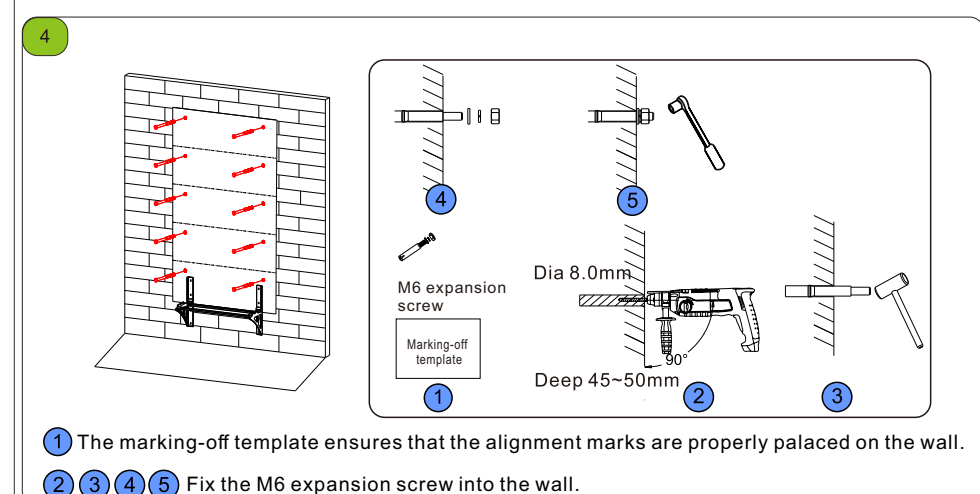
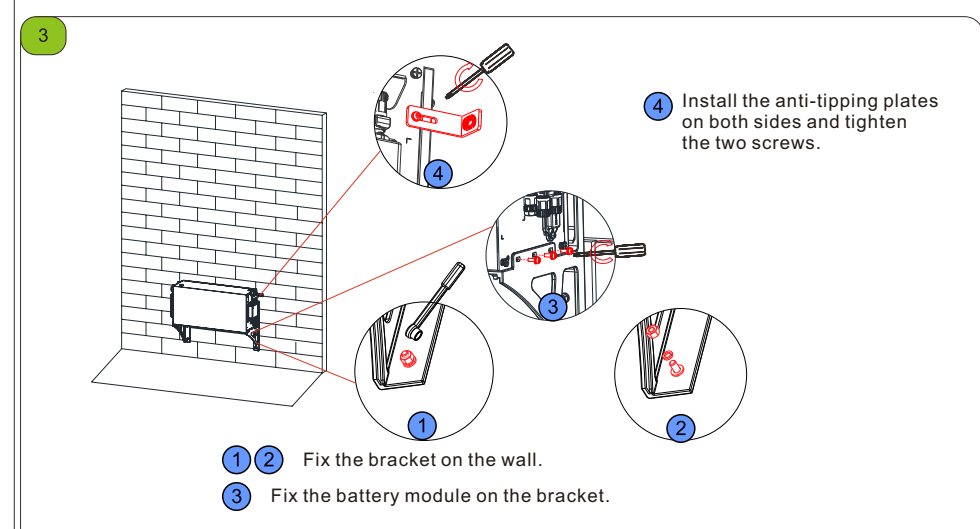
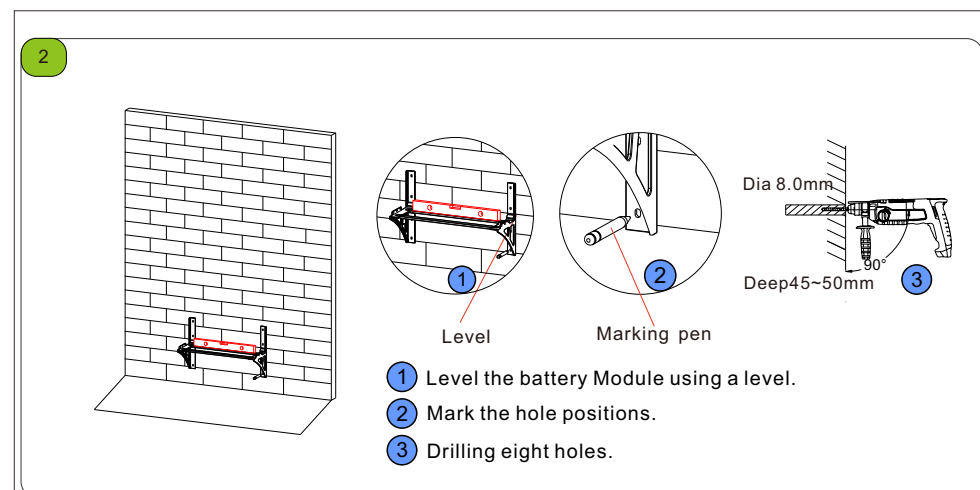

5.Wire Connection

5-1 APX 98034-P2 terminal & key description

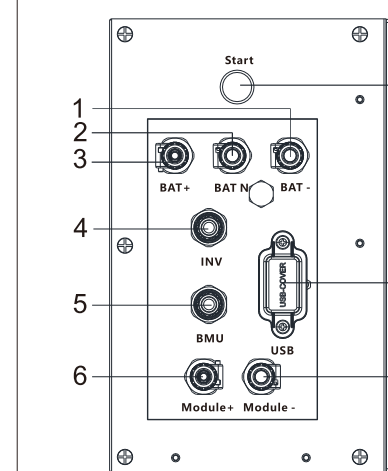

1	BAT -	Battery negative terminal to connected to the PCS
2	BAT N	Battery neutral terminal to connected to the PCS
3	BAT +	Battery positive terminal to connected to the PCS
4	INV	Communication terminal connect to the PCS
5	BMU	Communication terminal connect to the battery module (Link-in)
6	Module+	Connect to the positive battery terminal of the Battery Module (B+)
7	Module-	Connect to the positive battery terminal of the Battery Module (B-)
8	USB	USB terminal
9	Start	Start key

5-2 APX 5.0P-B1 Connection end face introduction

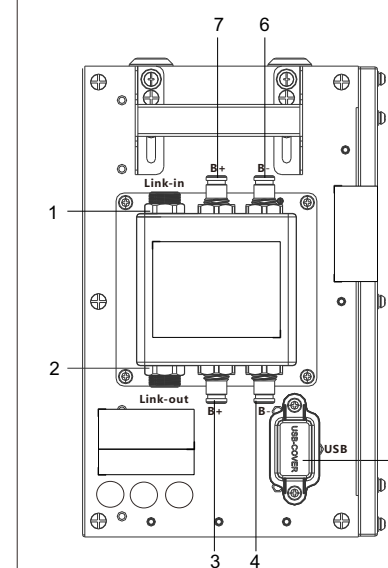

1	Link-in	Communication terminal Connect to another BM(Link-out) or the PM(BMU)Communication
2	Link-out	Communication terminal Connect to another BM(Link-in)
3	B+	Battery positive terminal Connect to another BM (B+)
4	B-	Battery negative terminal Connect to another BM (B-)
5	USB	USB terminal
6	B-	Battery negative terminal Connect to another BM (B-) or the PM (Module-)
7	B+	Battery positive terminal Connect to another BM (B+) or the PM (Module+)

5-3 Battery Capacity Description

The battery supports power and capacity expansion. Two power control modules can be connected in parallel. A maximum of six battery modules can be connected to a single power module.

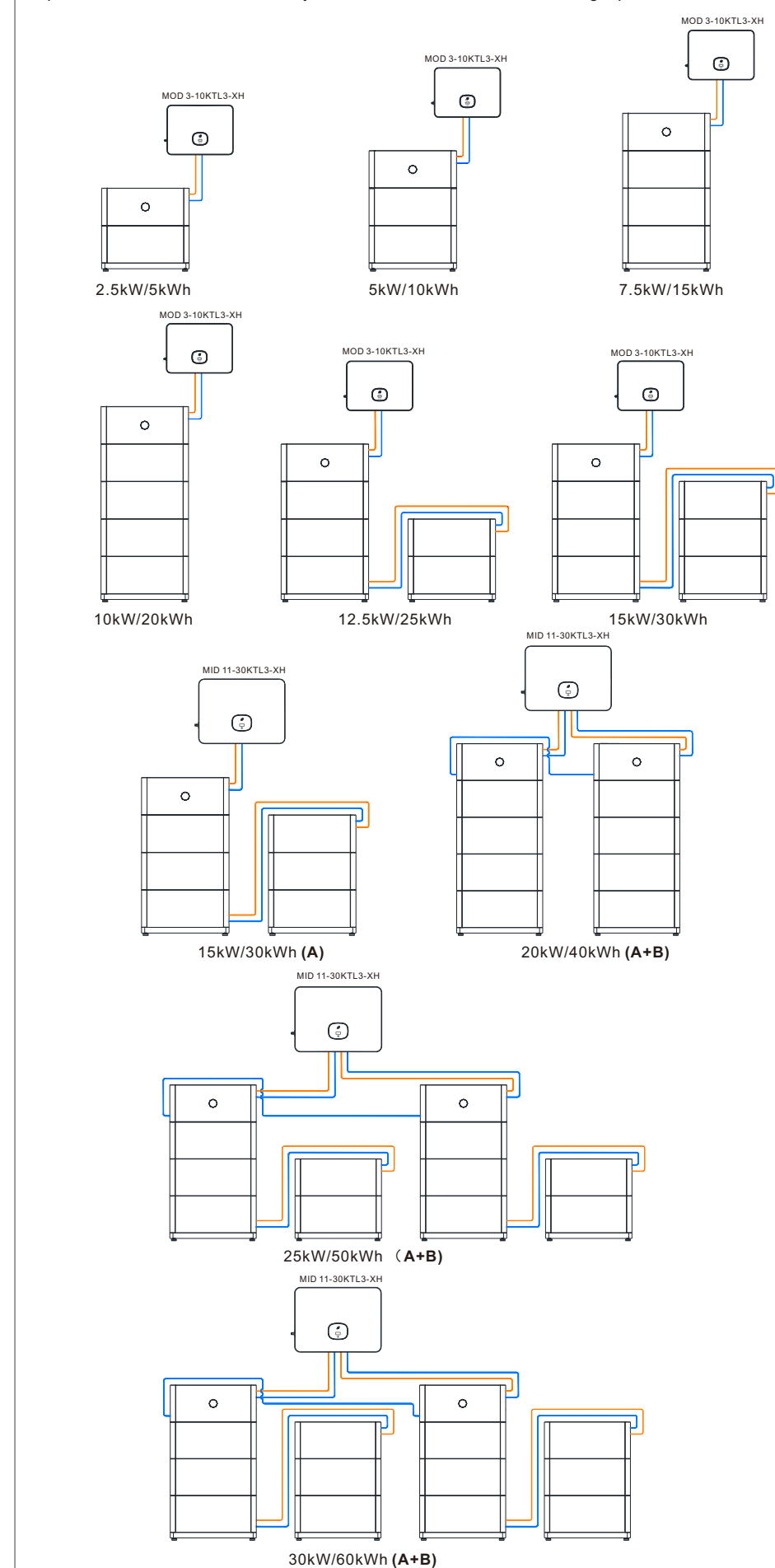

5-4 Wiring diagram

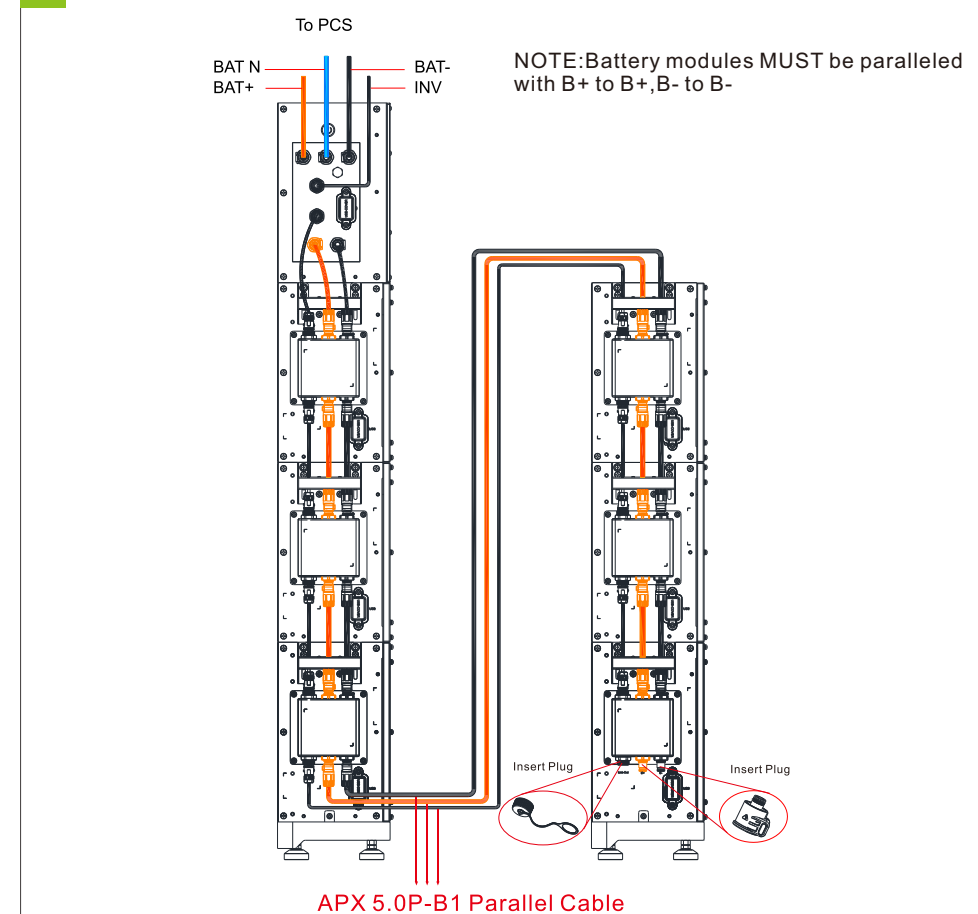

wire connection sequence:
ground cable → communication cable → power cable

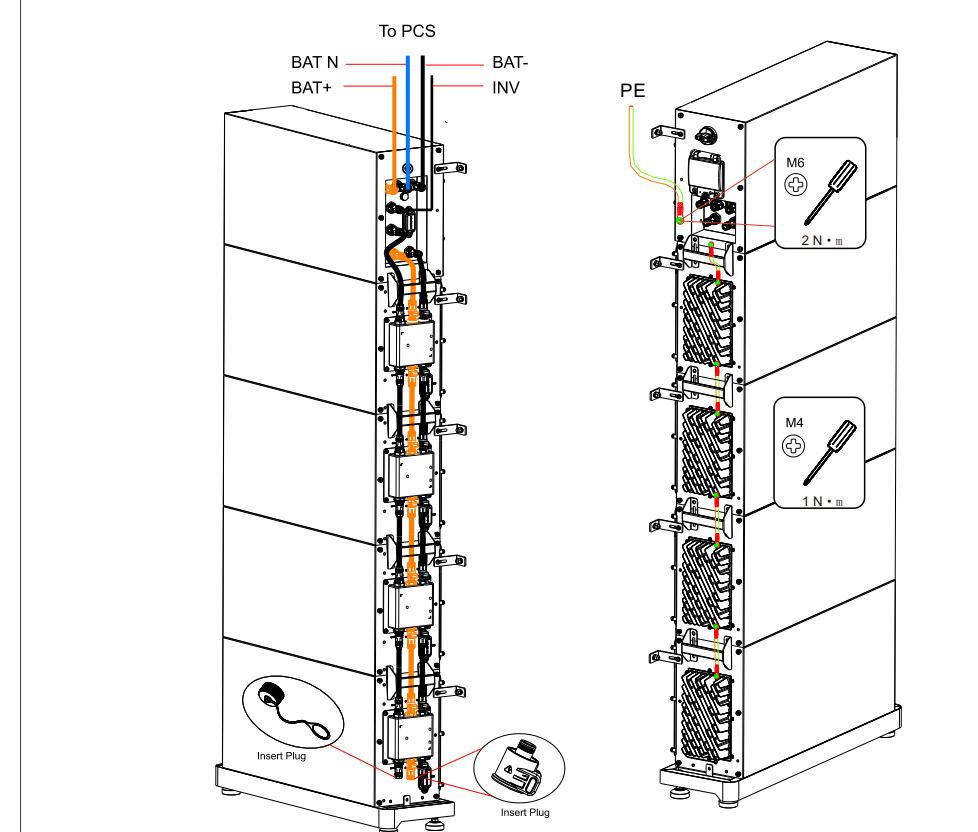

Note: It is not recommended to install a DC circuit breaker between the battery system and the PCS. If you want to install a DC circuit breaker with rated working voltage greater than 1000V and rated working current greater than 63A, do not operate the DC circuit breaker with power-on, otherwise the machine may be damaged.

5-5 Routing Cables Out of the Cable Hole

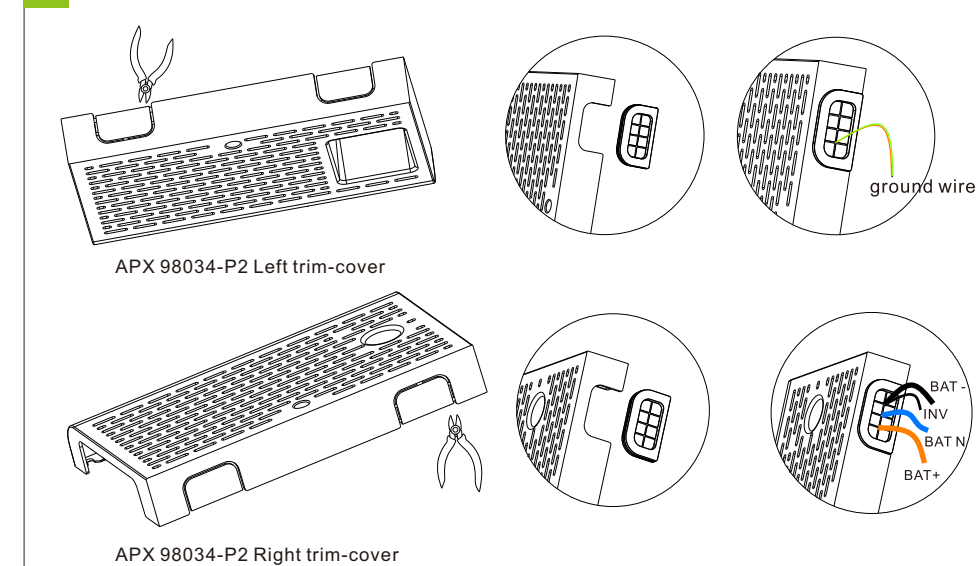

5-6 Communication port connection

APX 5.0-30.0P-S2			MOD 3-10KTL3-XH			MID 11-30KTL3-XH			
Silk screen	Terminal serial number	Definition	Silk screen	Terminal serial number	Definition	Silk screen	Terminal serial number	Definition	
INV	1	WAKE-(W-)	COM	10	BAT.EN-	A	10	30	BAT.EN-
	2	WAKE+(W+)		9	BAT.EN+		B	9	29
	7	RS485_B(B)		8	RS485B2	COM		8	28
	8	RS485_A(A)		7	RS485A2		7	27	RS485A2

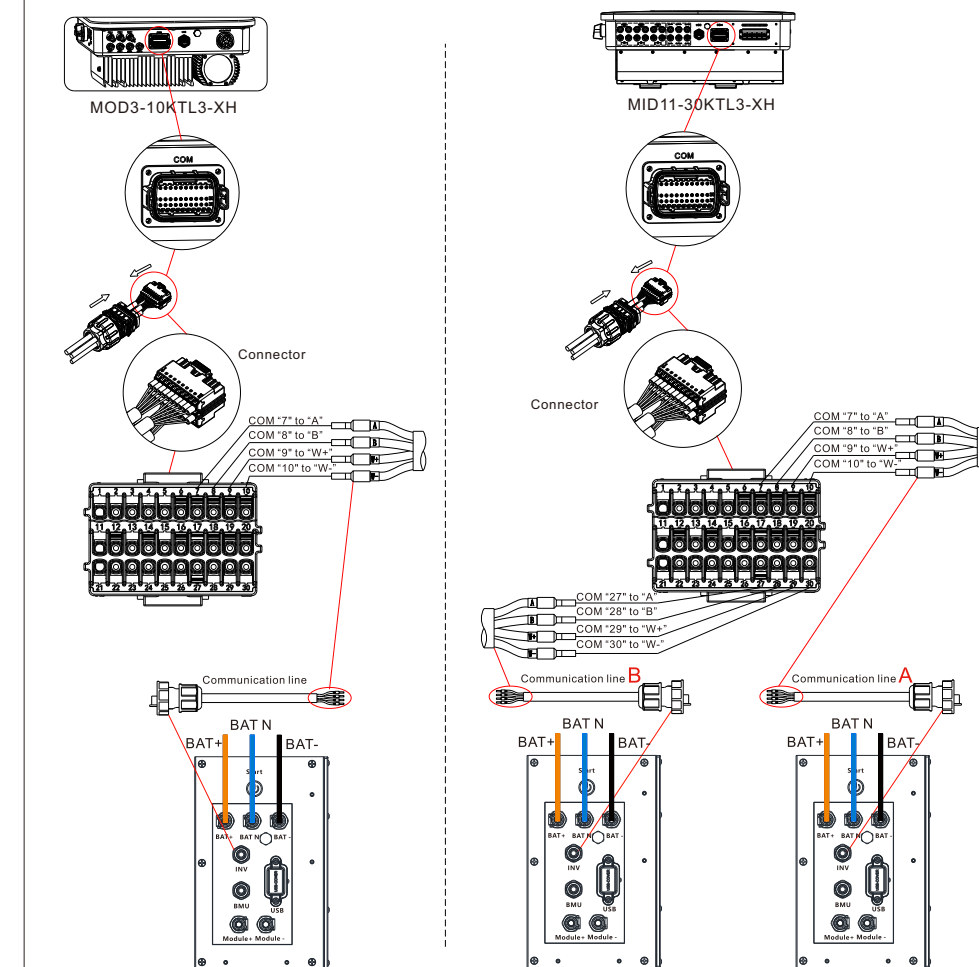

6.Terminal Connection

6-1 Power terminal

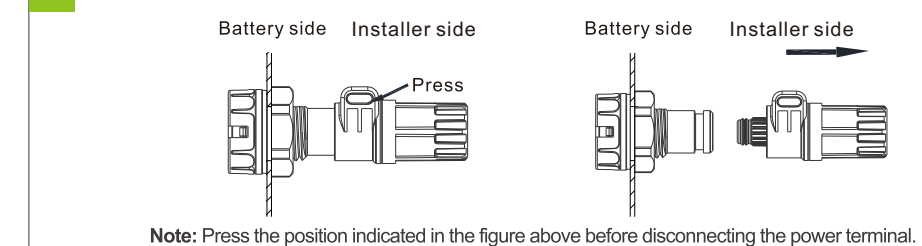

6-2 Installing the trim-cover

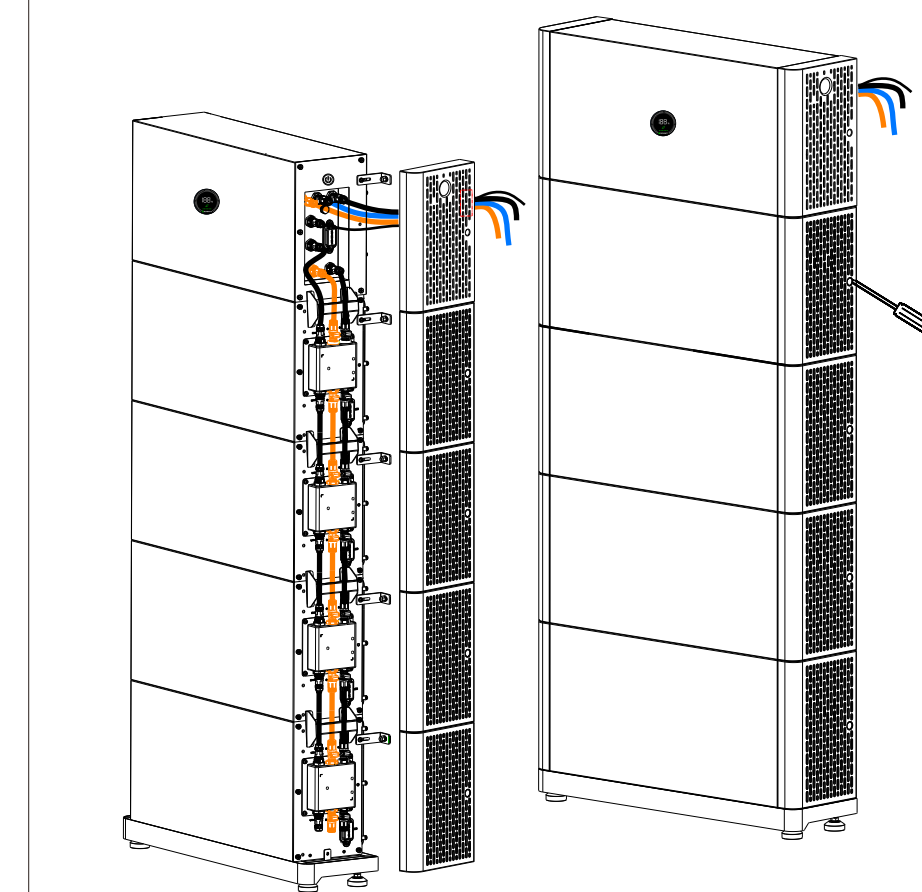

7. Key operation

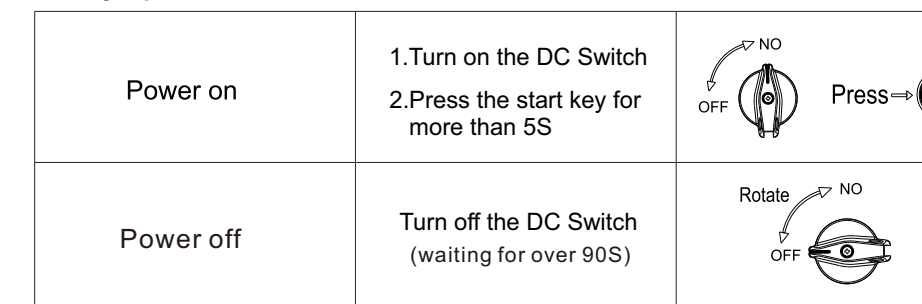

Note: 1. Before performing maintenance and repair work, ensure that the AC circuit breaker and the PV switch of the PCS, as well as the switch of the APX are disconnected. Wait for 15 minutes after the system is powered off and make sure that the LOGO (GROWATT) indicator on the APX is off. Do not perform any operations until the system is completely shut down.
2. When multiple battery systems are used in parallel connection, you only need to press the start key of one module to start the system.

8. Service and contact

Shenzhen Growatt New Energy Co., Ltd
4-13/F, Building A, Sino-German (Europe) Industrial Park, Hangcheng Ave, Bao'an District, Shenzhen, China
+86 755 2747 1942
service@ginverter.com
www.ginverter.com

